

# SMH5-FM Quick Start Guide

A full version of the manual is downloadable at [www.senablueetooth.com](http://www.senablueetooth.com).

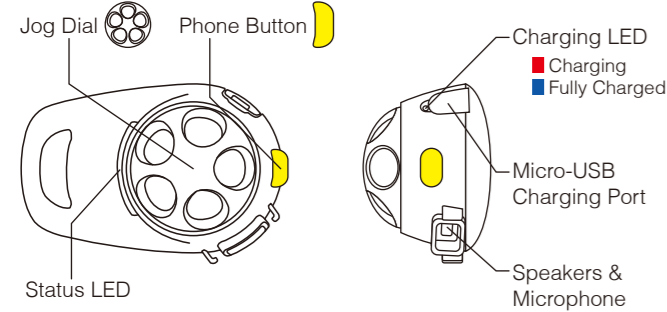

## Installation

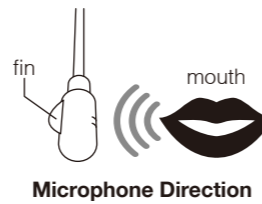
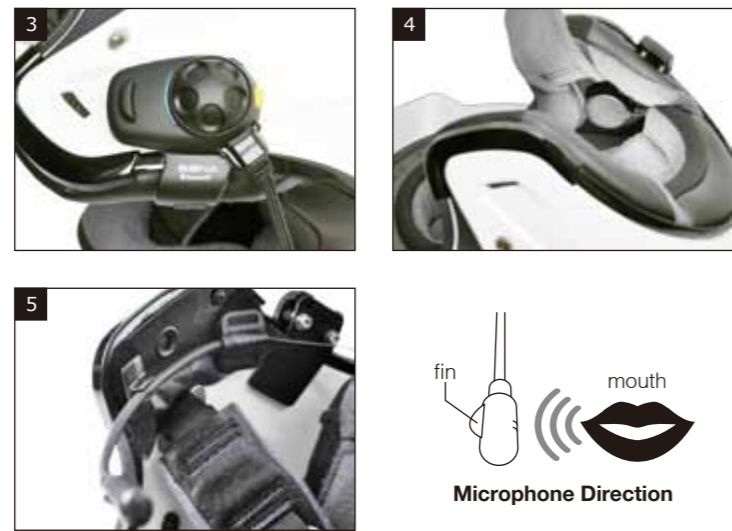

## Button Operation



## Power On/Off

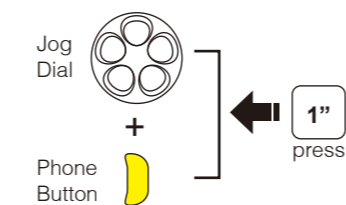

## Volume Adjust

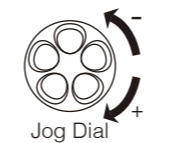

## Battery Check

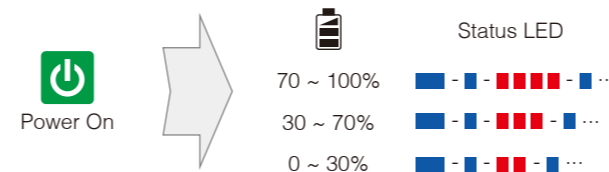

## Bluetooth Pairing Phone, MP3, GPS

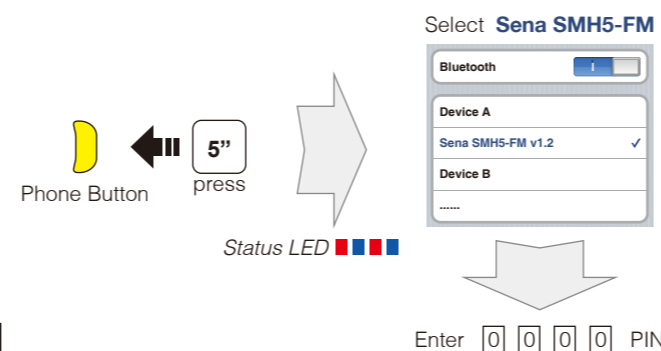

## Mobile Phone

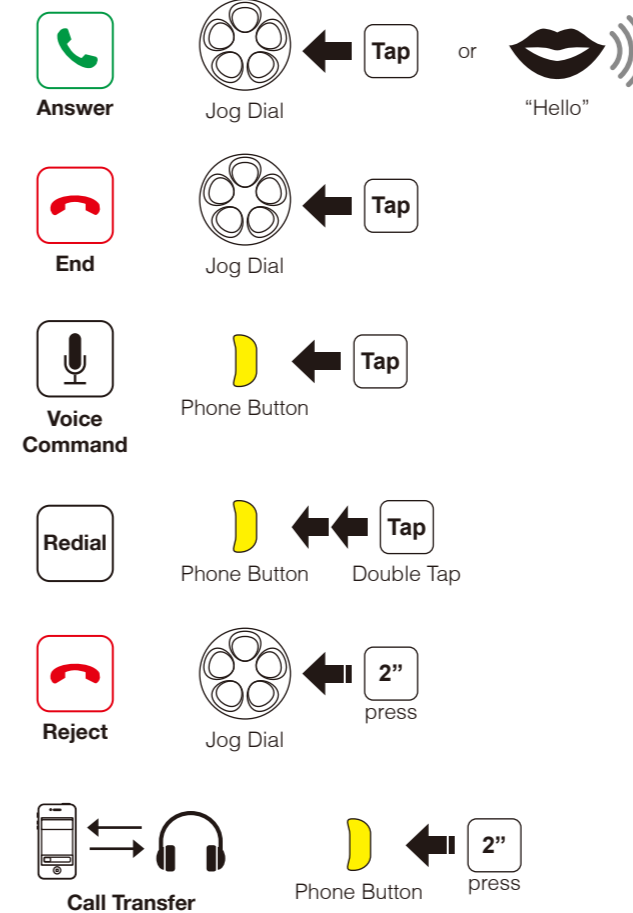

## Phone VOX Setting

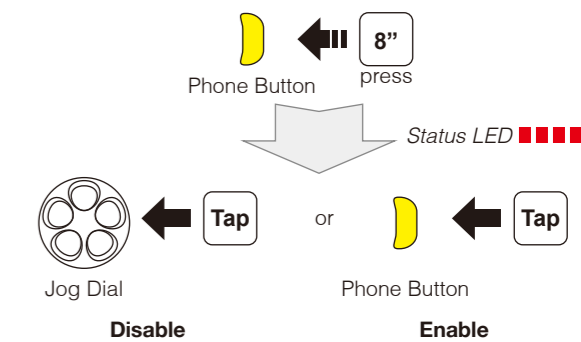

## Music

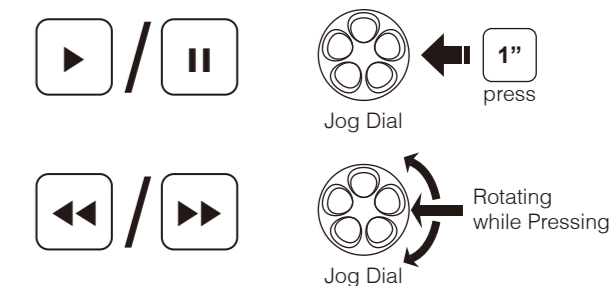

## Headset Pairing Intercom

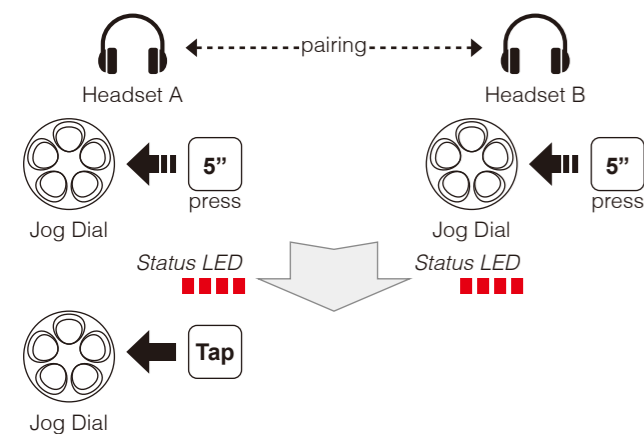

## Multiple Headset Pairing Last Come, First Served

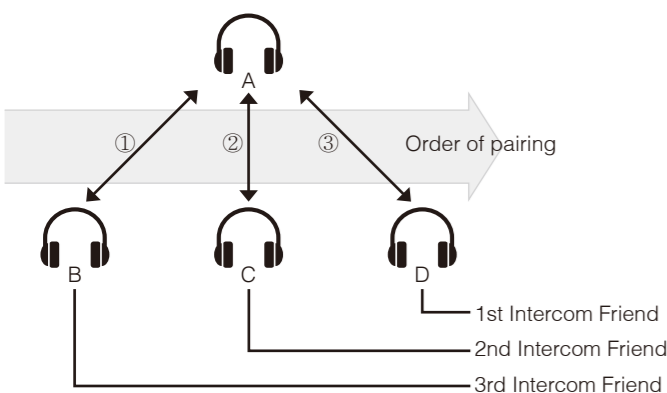

## Start Intercom

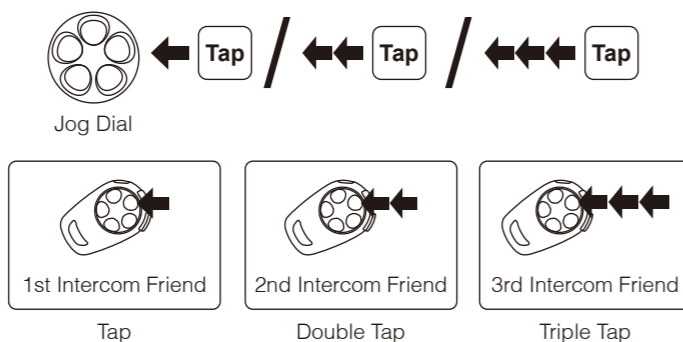

## End Intercom

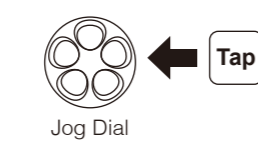

## Factory Reset

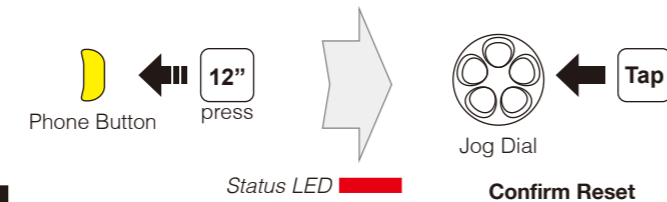

## Radio On/Off



## Radio Seek Stations

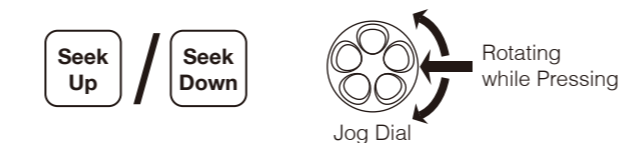

## Radio Scan Up FM Band

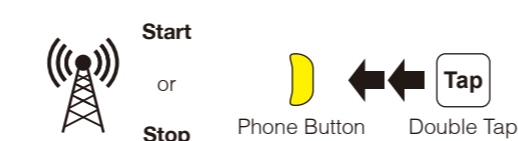

## Save to preset while scanning



## Radio Save or Delete Preset

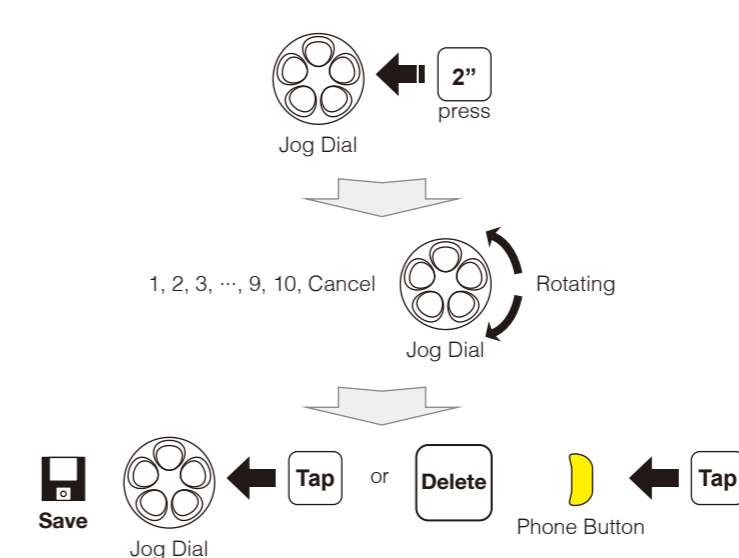

## Radio Move to Preset Station

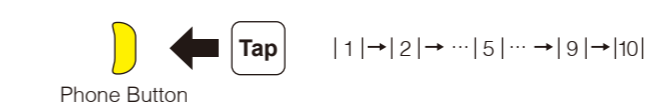

Refer to the full version of the manual for **Temporary Preset** and **RDS (Radio Data System) On/Off**.

## Optional Accessories

- Wired Microphone Clamp Kit
- Boom Microphone Clamp Kit
- Wired Microphone
- Cigarette Charger

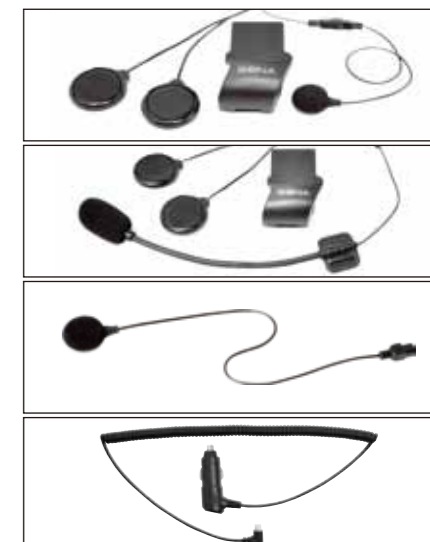

**Sena Technologies, Inc.**  
3150 Almaden Expressway, Suite 238, San Jose, CA 95118, United States  
12-14 Rond-point des Champs-Élysées, 75008 Paris, France  
210 Yangjae-dong, Seocho-gu, Seoul 137-130, Korea (Republic of)

Customer Support: [support@senablueetooth.com](mailto:support@senablueetooth.com)

