

# SMH5 Quick Start Guide

A full version of the manual is downloadable at [www.senablueetooth.com](http://www.senablueetooth.com).

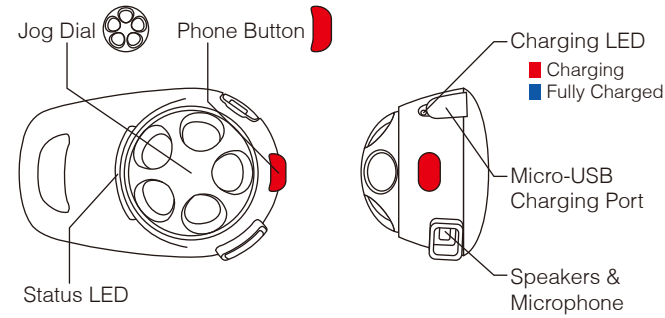

## Installation

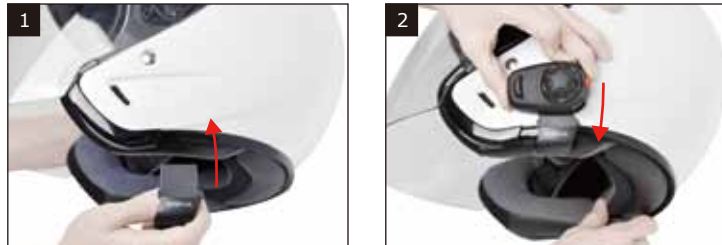

## Button Operation

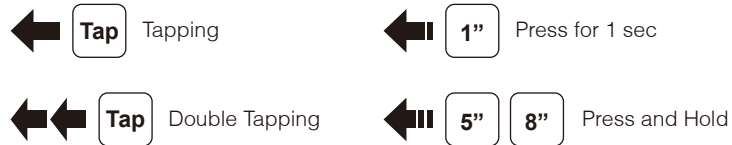

## Power On/Off

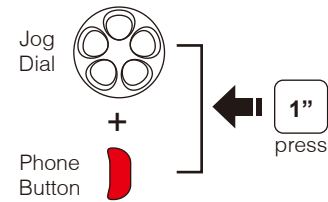

## Volume Adjust

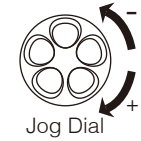

## Battery Check

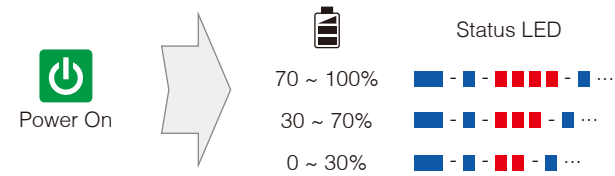

## Bluetooth Pairing Phone, MP3, GPS

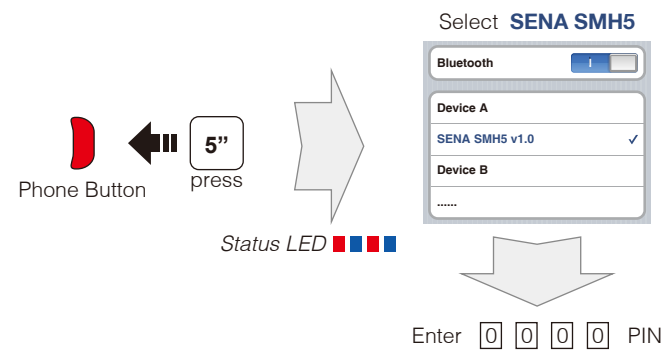

## Mobile Phone

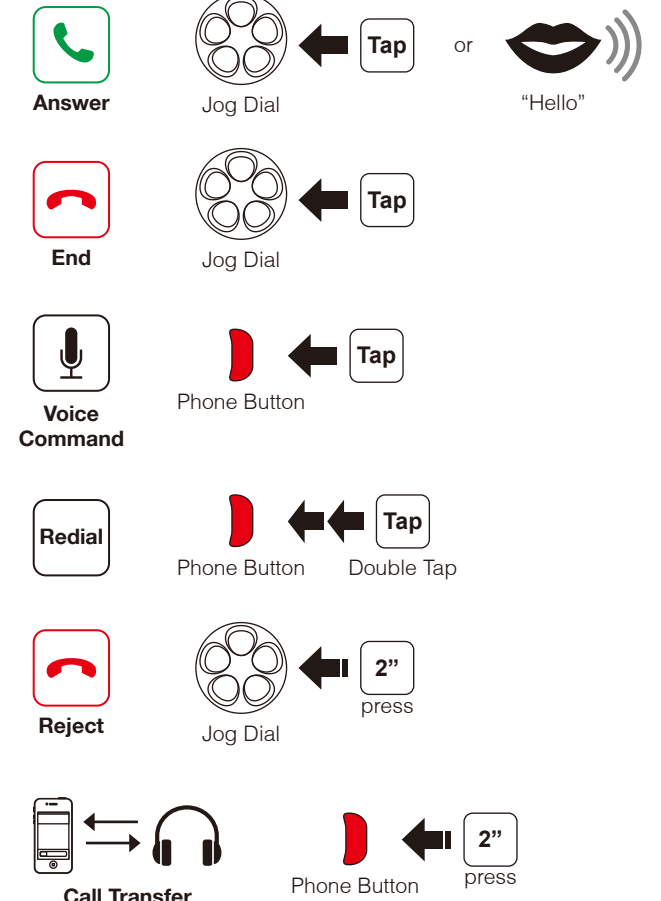

## Phone VOX Setting

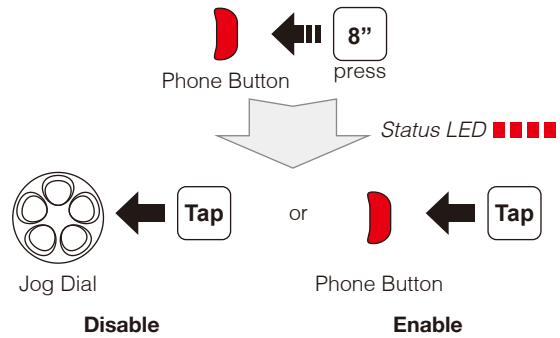

## Music

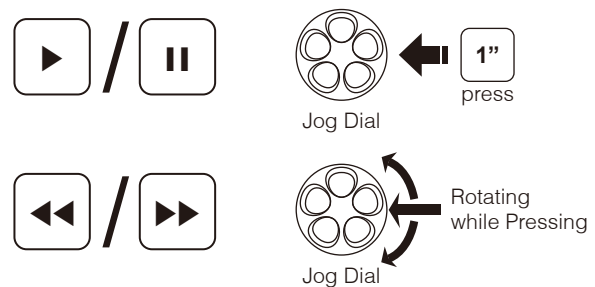

## Headset Pairing Intercom

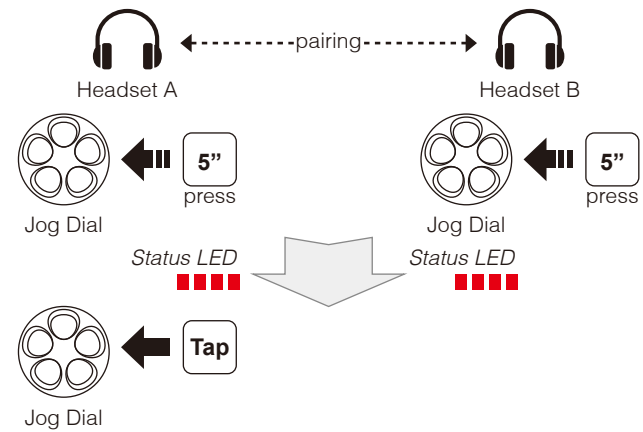

## Multiple Headset Pairing

Last Come, First Served

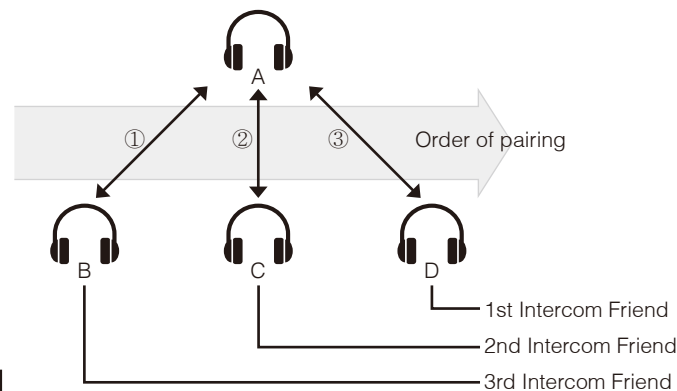

## Start Intercom

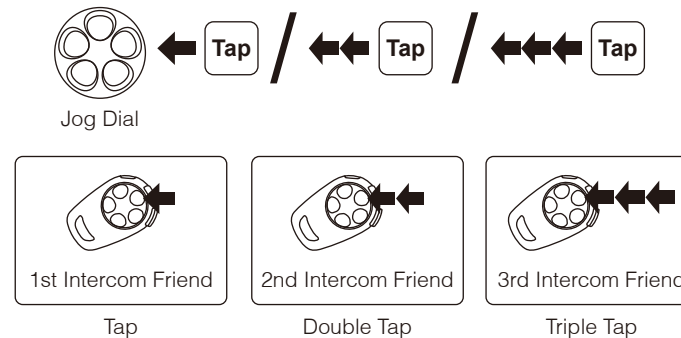

## End Intercom

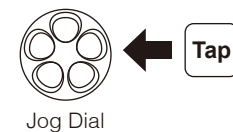

## Factory Reset

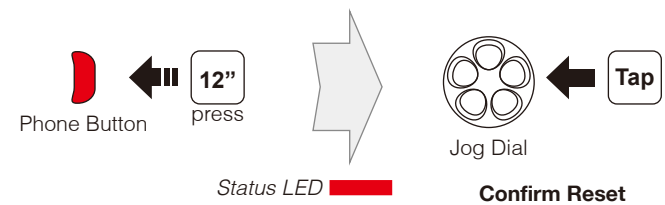

## Optional Accessories

- Wired Microphone Clamp Kit
- Boom Microphone Clamp Kit
- Wired Microphone
- Large Speaker Kit
- Cigarette Charger

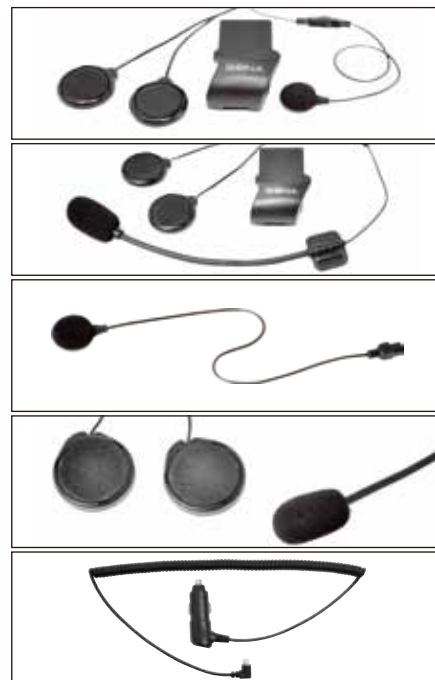

SENA Technologies, Inc.

3150 Almaden Expressway, Suite 238, San Jose, CA 95118, United States

12-14 Rond-point des Champs-Élysées, 75008 Paris, France

210Yangjae-dong, Seocho-gu, Seoul 137-130, Korea (Republic of)

Customer Support: [support@senablueetooth.com](mailto:support@senablueetooth.com)

SENA